

4.5

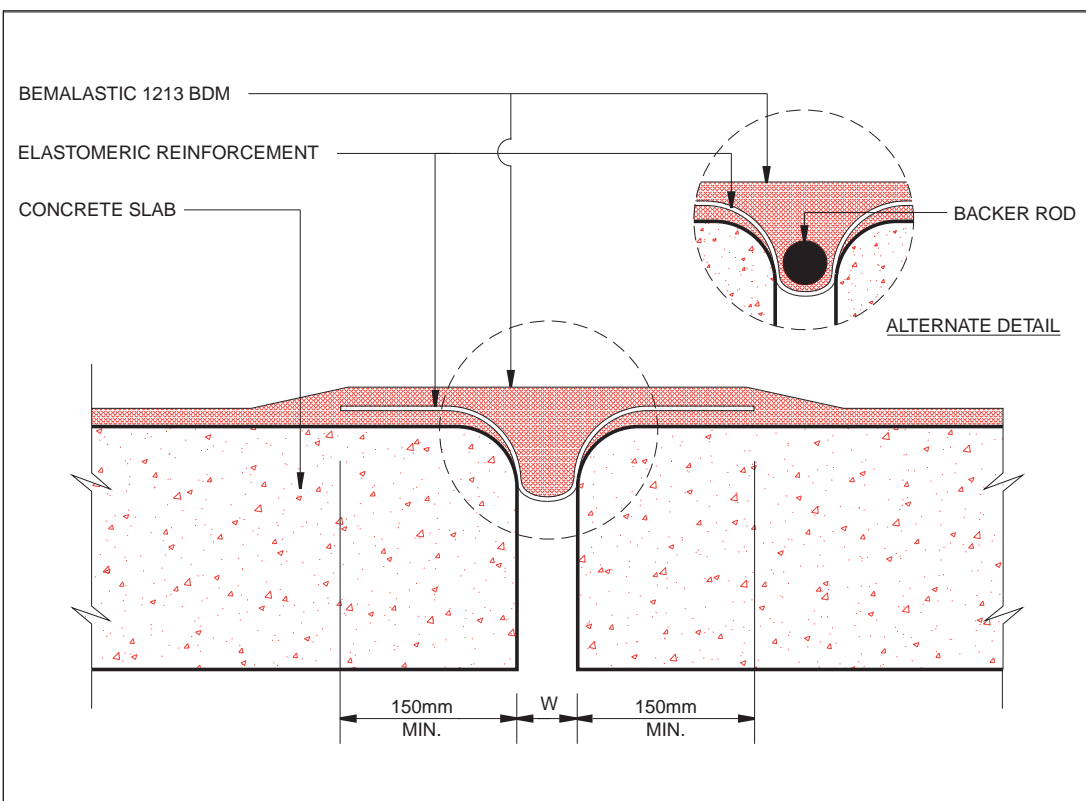

DATE	REVISION	BY

DATE FEB 26 1998
 DRAWN MA
 CHECKED
 APPROVED
 PRINTED

HORIZONTAL EXPANSION JOINT
 (Width over 12.5mm and less than 50mm)

BEMALASTIC 1213 WATERPROOFING SYSTEM



8800 SHEPPARD AVE. EAST
 SCARBOROUGH ONTARIO, M1B 2M4
 (416) 281-8181

DRAWING #: BEMAL08

4.6

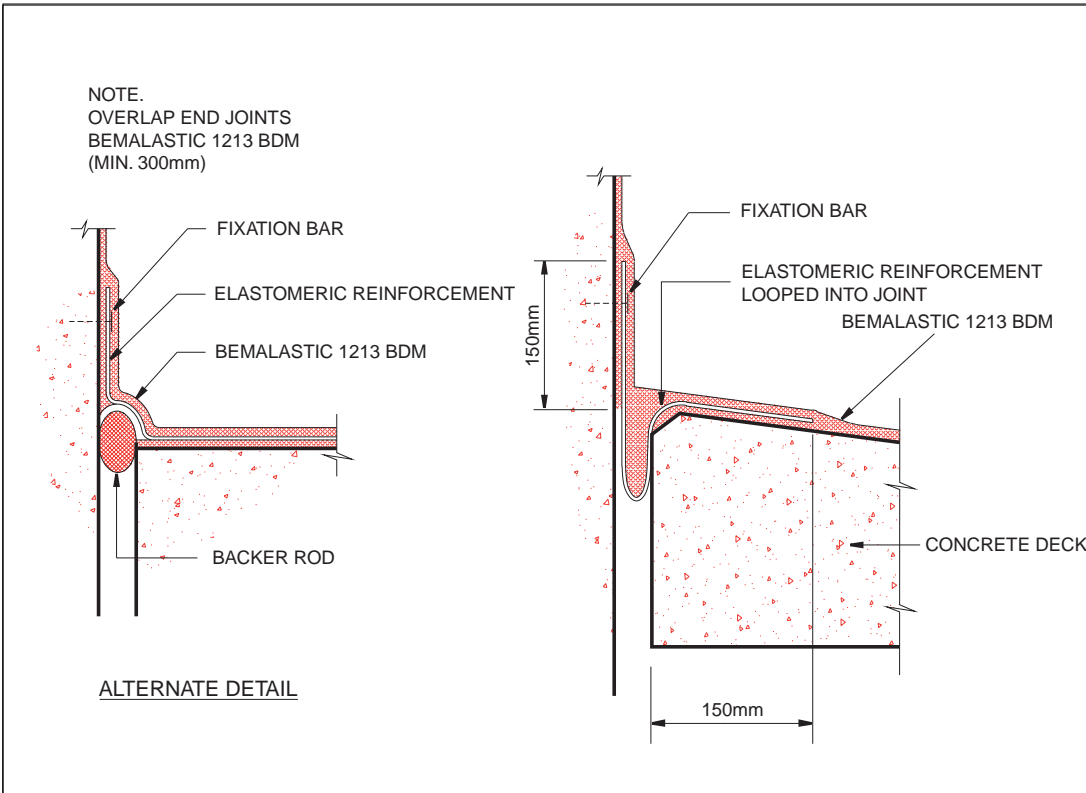

DATE	REVISION	BY

DATE FEB 26 1998
 DRAWN MA
 CHECKED
 APPROVED
 PRINTED

EXPANSION JOINT AT CHANGE IN PLANE -
 Single Ply Assembly

BEMALASTIC 1213 WATERPROOFING SYSTEM



8800 SHEPPARD AVE. EAST
 SCARBOROUGH ONTARIO, M1B 2M4
 (416) 281-8181

DRAWING #: BEMAL08